

SKETCH MAP SHOWING OVER R.S. PLOT NO.- 1/524(P), L.R. PLOT NO.- 80, L.R. KHATIAN NO- 1752, MOUZA- SANKARPUR, J.L. NO. - 109, P.S.- NEW TOWNSHIP, DIST - PASCHIM BARDHAMAN..

OWNER'S NAME-
PRANKRISHNA DAS

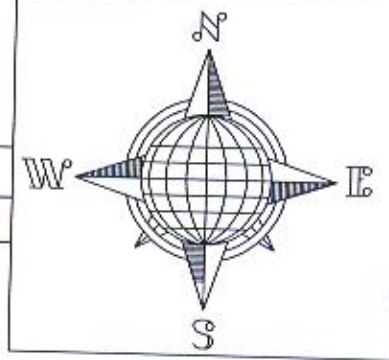

LAND AREA :- 11 DECIMAL

OWNER'S PLOT SHOWING IN RED COLOUR

BOUNDARY R.S. PLOT NO.- 1/524(P)
 EAST- R.S.PLOT NO.- 1/524(P)
 WEST- 10'-0" WIDE ROAD, R.S.PLOT NO.- 1/524(P)
 NORTH- 12'-0" WIDE ROAD
 SOUTH- R.S.PLOT NO.- 30

MEASUREMENTS

EAST- 50'-0", 51'-0"
 WEST- 55'-0", 46'-0"
 NORTH- 52'-0", 40'-0"
 SOUTH- 55'-0", 40'-0"

R.S.PLOT NO.- 1/524(P)
 L.R.PLOT NO.- 80
 LAND AREA- 11 DEC.

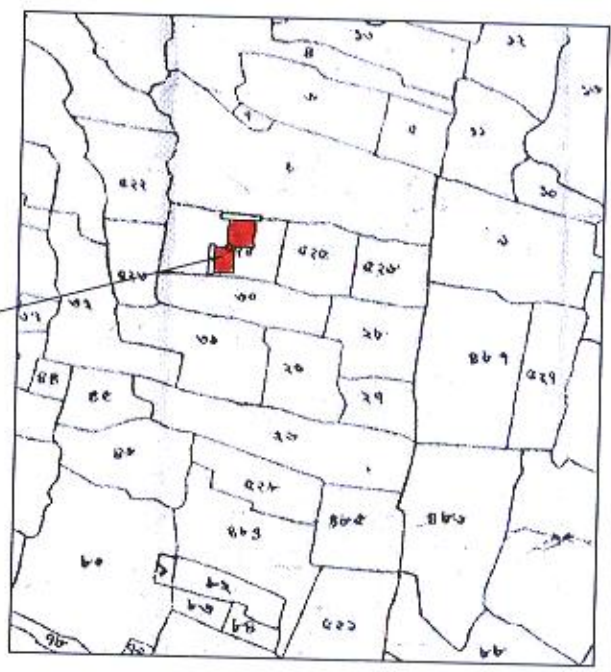

INDEX MAP

(SCALE :- 1"=330')

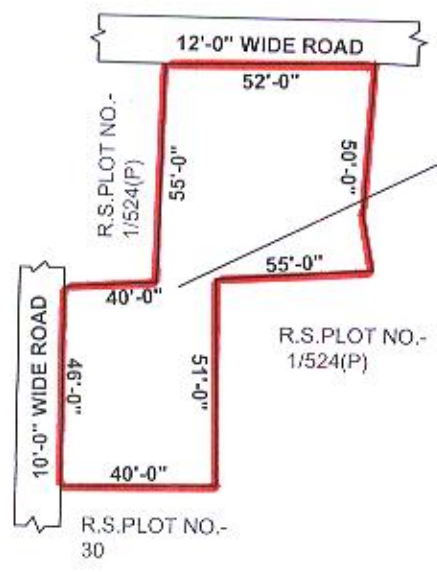

R.S.PLOT NO.- 1/524(P)
 L.R.PLOT NO.- 80
 LAND AREA- 11 DEC.

Sanatan Chatterjee
 Sanatan Chatterjee
 Land Surveyor
 Govt. Regd. No.-BSS-139-15

SIGNATURE OF OWNER

DRAWN BY